

### COMET TORQUE CONVERTERS FOR ALL ENGINES THRU 8 H.P.

#### JR. DRAGSTER, GO KARTS, MINI BIKES

#### MODEL 340 SERIES (SYMMETRICAL)

##### GENERAL INFORMATION:

The Model 340 automatic torque converter system was designed specifically for light horsepower applications such as mini-bikes and other lightweight sports vehicles as well as industrial applications. Generally engine driven, this converter is of the torque sensitive type in which the vehicle or driven load has influence on establishing the ratio between the driver and driven. In normal operation, the driver "shifts into high" in response to the engine's increase in speed; the driven follows this speed change as in any variable pitch belt drive. In the torque sensitive design, a cam actuator in the driven reacts to increased torque demands by downshifting without loss of engine r.p.m. In this way, the engine continues to operate at peak power range for all but the most severe loads when it will shift into peak torque range.

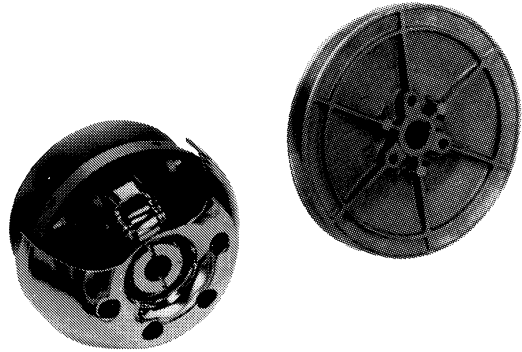

### SPECIFICATIONS

#### DRIVING RATIO

2.5:1 at engagement up to 0.8:1  
overall ratio 3.16:1

#### ENGAGEMENT RPM (4-CYCLE)

See Engagement Chart  
(Back Page)

#### MAXIMUM SPEED

8500 r.p.m.

#### PULLEY DIAMETERS/WEIGHTS

Driver — 4.8"                      2-1/2 Lbs.  
Driven — 6"                        1-3/4 Lbs.

#### PULLEY BORES - DRIVER & DRIVEN

5/8" — 3/4"

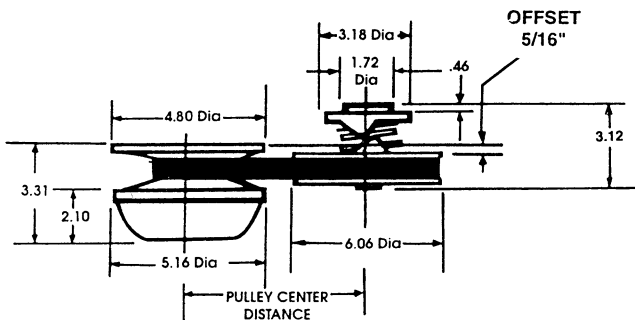

#### MODEL 340 SYSTEM INSTALLATION INSTRUCTIONS

##### IMPORTANT!

Torque converter DRIVE UNIT MUST NOT FLOAT on engine crankshaft. It must be bolted tight against engine crankshaft shoulder. Recommended Torque for bolt: To 30 ±5 ft. lbs..

BELT-3/4 TOP WIDTH STANDARD ADJUSTABLE TO RETRO THE 330 SERIES 5/8 TOP WIDTH.

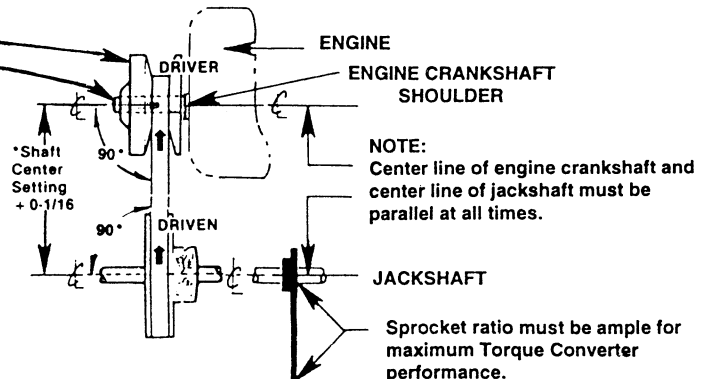

**ENGAGEMENT** — See Calibration Guide  
**BELT TOP WIDTH** — 3/4 Inches  
**MAX. PULLEY DIA.** — 4.8 Inches  
**MIN. PULLEY DIA.** — 2.24 Inches

## MODEL 340 SERIES

**\*Drive Clutch less Arms and Springs**  
 SEE BACK PAGE FOR SELECTION OF ITEMS 6, 7 & 10

302374A 5/8" Bore — 3/16 Keyway  
 302377A 3/4" Bore — 3/16 Keyway

### PARTS LIST & ASSEMBLY SEQUENCE

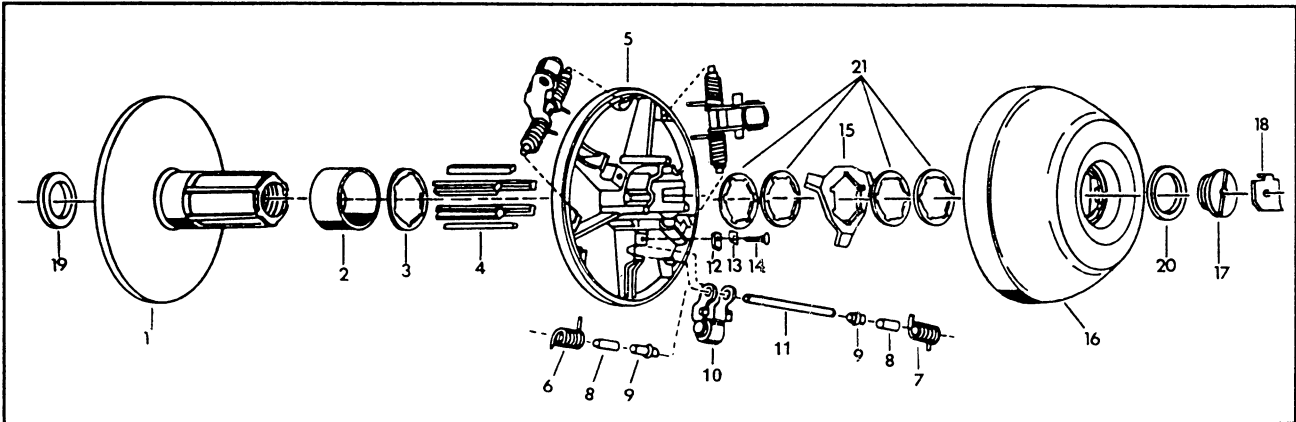

ITEM	NUMBER	DESCRIPTION	QTY/UNIT
1	See Kit	Fixed Face & Stem	1
2	300175A	Idler Bushing	1
3	300179A	Splined Washer	1
4	302373A	Spline Liner	6
5	302362A	Movable Face	1
6	—	R.H. Spring (See Engagement Chart-Back Page)	3
8	See Kit	Bushing Spring	6
9	See Kit	Bushing	6
10	—	Roller Kit (See Engagement Chart-Back Page)	3
11	See Kit	Pivot Pin	3
12	See Kit	Clamp, Pivot Pin	3
13	See Kit	Lock Plate	3
14	See Kit	Screw	3
15	300876A	Retractor	1
16	302383A	Ramp Plate	1
17	302365A	Retainer w/Retainer Spacer	1
18	300183A	Lock Washer	1
19	300090A	Spacer, Thrust	1
20	302361A	Retainer Spacer	1
21	302359A	Shim	4

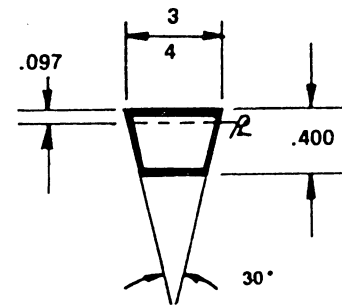

TYPICAL BELT CROSS SECTION  
 REFERENCE ONLY

\*See Engagement Chart on Back Page

Pivot Pin Kit  
 302203A Includes  
 Item # 8-9-11-12-13-14

Spring Bushings  
 302253A Includes  
 Item # 8-9-13

Fixed Face & Post  
 5/8" 302369A  
 3/4" 302370A  
 Item # 1

**COMET/SALSBUURY**

# MODEL 340 SERIES Driven Clutch

BELT TOP WIDTH 3/4 Inches  
PULLEY DIA. 6 Inches

302344A 5/8" Bore- 3/16 Keyway  
302345A 3/4" Bore- 3/16 Keyway

## PARTS LIST & ASSEMBLY SEQUENCE

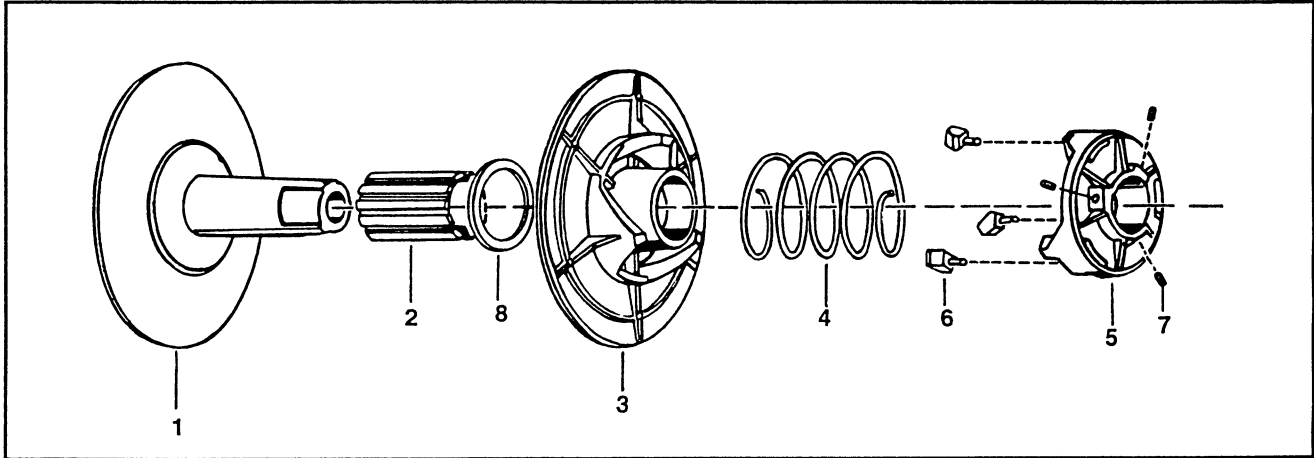

<u>ITEM</u>	<u>PART NUMBER</u>	<u>DESCRIPTION</u>	<u>QTY/UNIT</u>
1	300930A	Fixed Face and Post w/Bushing, 5/8" Bore	1
1	300847A	Fixed Face and Post w/Bushing, 3/4" Bore	1
2	300240A	Bushing	1
3	302346A	Moveable Face	1
4	300234A	Spring, Black	1
5	302364A	Cam w/Buttons	1
6	300172A	Buttons	3
7	214843A	Set Screw, 1/4-20 x 1/2	3
8	302347A	Spacer	1

**COMET/SALSBUURY**

## MODEL 340 DRIVE ENGAGEMENT CHART

The following engagement chart is based on static rotation testing only. In actual selection of components, the weight of the arm relative to the horsepower being transmitted should also be considered.

**NOTES:** Although different combinations of weights and springs might result in the same engagement RPM, the heavier weights and stronger springs cause quicker upshifts (lower RPM) and slower backshifts (lower RPM).

SPRING KITS		ROLLER KITS				
		BLACK w/Alum. Bushing w/Red Alum.Rivet	BLACK w/Steel Bushing w/Plain Steel Rivet	PINK w/Steel Bushing w/Plain Steel Rivet	ORANGE w/Steel Bushing w/Plain Steel Rivet	GREEN w/Steel Bushing w/Plain Steel Rivet
<b>PART NO.</b>	<b>COLOR</b>	<b>301031A</b>	<b>300114A</b>	<b>300127A</b>	<b>300126A</b>	<b>301330A</b>
		<b>27 GRAMS</b>	<b>35 GRAMS</b>	<b>41 GRAMS</b>	<b>46 GRAMS</b>	<b>55 GRAMS</b>
302221A	BLACK	2800	2300	2200	1900	1700
302222A	PINK	4000	3300	3200	2700	2400
302223A	GOLD	4300	3500	3400	2900	2600
302225A	PURPLE	4900	4000	3900	3400	3000
302224A	BLUE	5600	4600	4500	3800	3500

## MODEL 340 DRIVER/340 DRIVEN RECOMMENDED BELT SPECIFICATIONS

COMET ORDER NO.	CENTER DISTANCE SETTING	APPROX. BELT O.C.
203578A	6 15/16 - 7	27.36
203579A	7 1/8 - 7 3/16	28.32
203580A	7 9/16 - 7 5/8	29.28
203581A	8 3/16 - 8 1/4	30.25
203582A	8 11/16 - 8 3/4	31.23
203583A	9 3/16 - 9 1/4	32.20
203584A	9 5/8 - 9 11/16	33.18
203585A	9 15/16 - 10	33.78
203586A	10 3/4 - 10 13/16	35.14
203587A	11 11/16 - 11 3/4	37.11
203588A	13 1/16 - 13 1/8	39.77